

Lal Lal Wind Farms

Horsehill Road closure, crane movements

September 2019



Crane movements across Horsehill Road

Crane movements are required across Horsehill Road and Horsehill Road South to complete works on turbine construction of Tower 2. Details are in the Traffic Management plan below for the temporary closure.

To make it safe for our project neighbours and the travelling public, Horsehill Road will be closed occasionally during a 1-week period, commencing Monday 9th September. Closures will be intermittent, however detours are available to ensure no delays are incurred if any unforeseen circumstances occur.

Traffic Management: details of road closure Horsehill Road

Traffic management will be in place with a diversion down Narmbool Road. Residents that live in the exclusion zone will still have access in and out. All other members of the public will be diverted down Narmbool Road. Construction traffic will be using Mt Mercier Road.

Closure of Horsehill Road

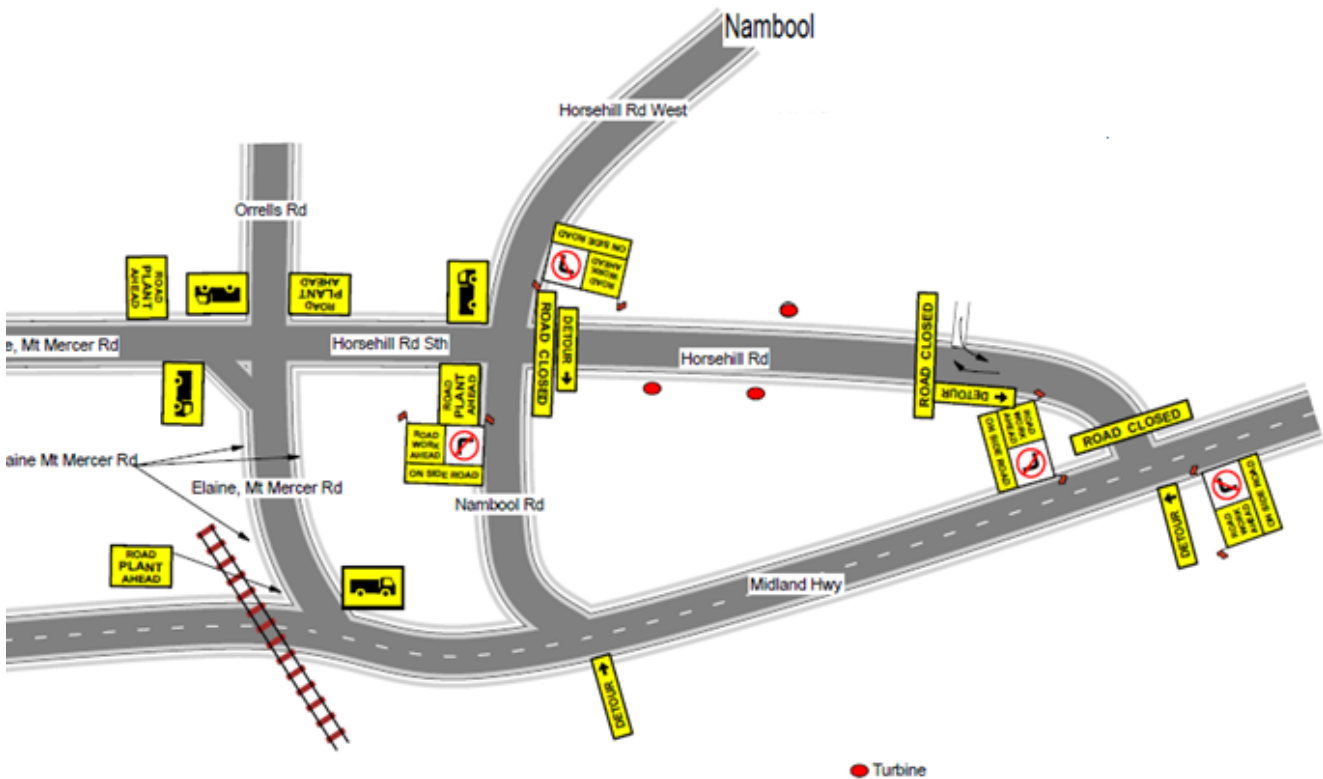

Construction work hours

Construction work hours with the crane lift will be between 6am and 6.30pm, Monday to Sunday. These works are authorised to take place out of hours to avoid windy weather. We apologise for any inconvenience caused by these works and your patience is most appreciated.

Future construction updates

Further construction updates to follow via community bulletins distributed in the local area.



For more information

Email info@lallalwindfarms.com.au

Phone 1800 187 183

Web www.lallalwindfarms.com.au

Visit Buninyong Information Centre, Warrenheip Street Buninyong

