

Lal Lal Wind Farms

Horsehill Road closure, crane movements

May 2019



Crane movements across Horsehill Road

Crane movements are required across Horsehill Road and Horsehill Road South to complete works on turbine construction of towers 23, 24, 10, 3, 2 and 1. Details are in the Traffic Management plans below for the temporary closures.

To make it safe for our project neighbours and the travelling public, Horsehill Road and Horsehill Road South will be closed occasionally during a 4-week period, commencing Tuesday 18 June. Closures will be less than an hour at a time, however detours are available to ensure no delays are incurred if any unforeseen circumstances occur.

Traffic Management: details of road closure Horsehill Road

Traffic management will be in place with a diversion down Narmbool Road. Residents that live in the exclusion zone will still have access in and out. All other members of the public will be diverted down Narmbool Road. Construction traffic will be using Mt Mercer Road.

Closure of Horsehill Road

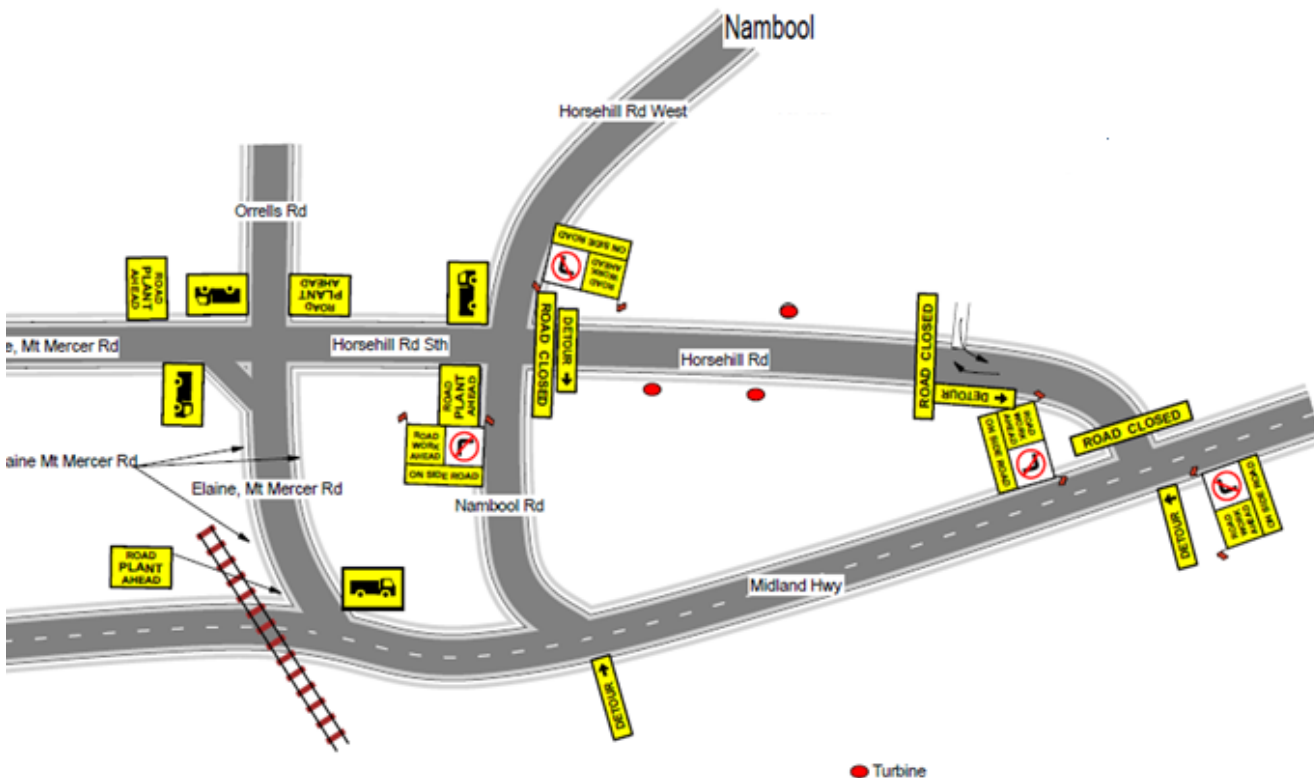

Traffic Management: details of road closure Horsehill Road South/West

Traffic management will be in place with a diversion down Orrells Road. Access to the Cemetery will be unaffected.

Closure of Horsehill Road South

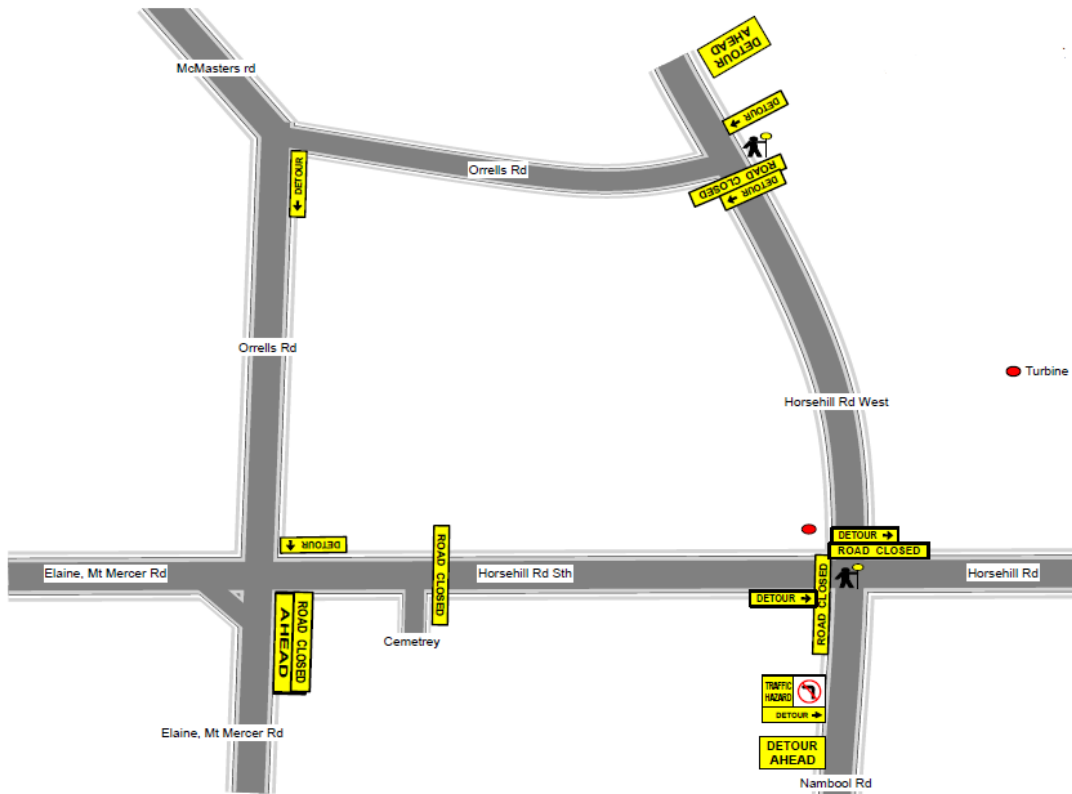

Please take note of detour signs and traffic management crew when travelling in the area. These works could be delayed due to weather conditions.

Construction work hours

Construction work hours will be 7am and 6.00pm, Monday to Sunday. These works are authorised to take place out of hours to avoid windy weather. We apologise for any inconvenience caused by these works and your patience is most appreciated.

Future construction updates

Further construction updates to follow via community bulletins distributed in the local area.



For more information

Email info@lallalwindfarms.com.au

Phone 1800 187 183

Web www.lallalwindfarms.com.au

Visit Buninyong Information Centre, Warrenheip Street Buninyong